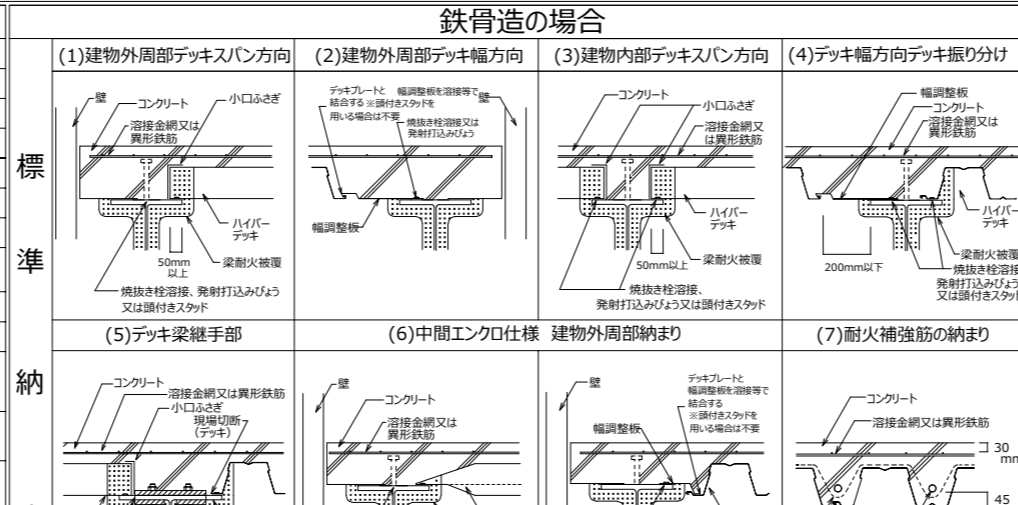
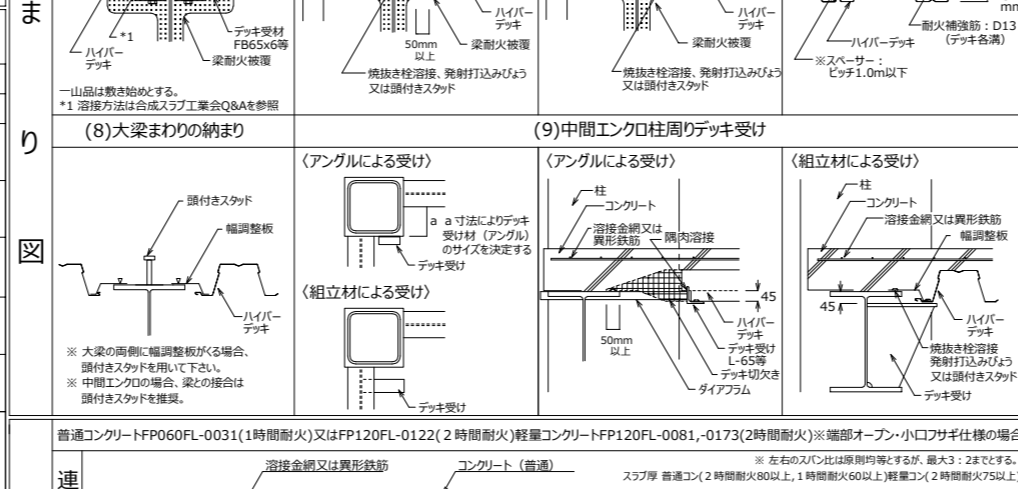

Table with columns for Deck Plate (品名, 板厚, 種類, 表面処理), Concrete (設計基準強度, デッキプレート山厚さ), and Deck Plate End Treatment (溶接金網または異形鉄筋, デッキプレート端部仕様, 梁との接合).



耐火認定条件 (Fire Rating Conditions) table with columns for fire resistance (耐火区分), certification number (認定番号), support conditions (支持条件), span (許容スパン), load (許容積荷重), thickness (コンクリート厚), and notes (備考).



条 (Notes) section containing important technical notes regarding span, load, and fire resistance requirements.

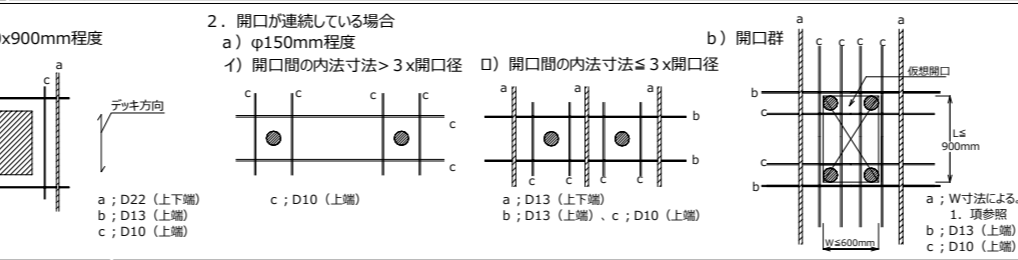
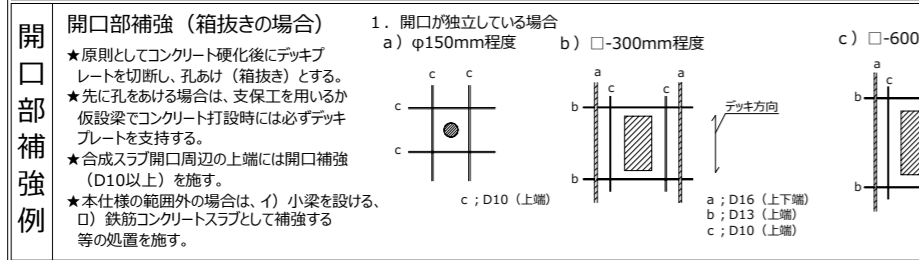
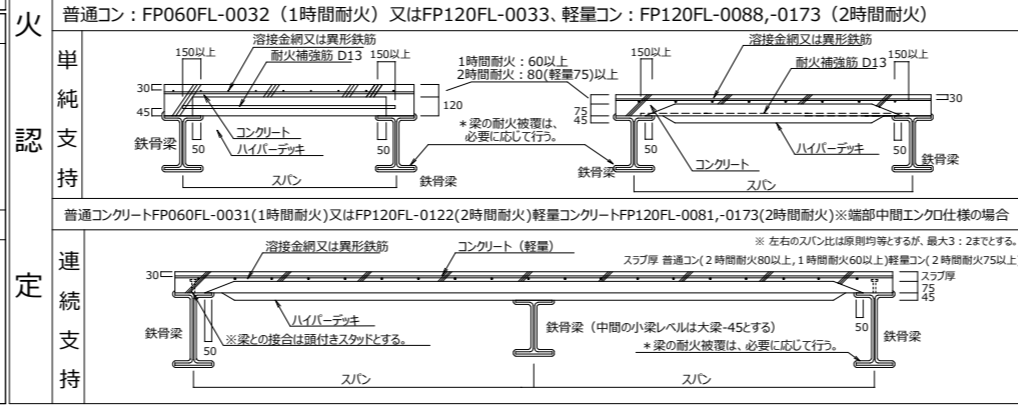
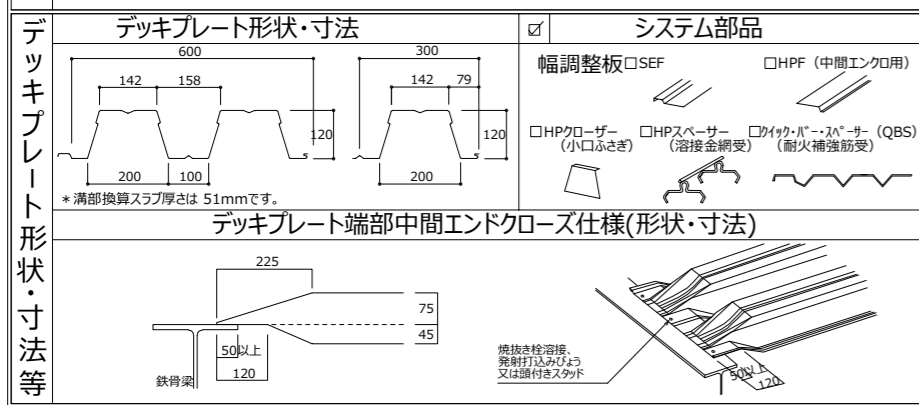

Construction and Reinforcement (施工) section containing 10 numbered steps: 1. Cutting plan, 2. Moving/Storage, 3. Spacing/Stopping, 4. Deck plate and beam connection, 5. End opening, 6. Insert work, 7. Opening reinforcement, 8. Welding mesh, 9. Concrete pouring, 10. Curing. Includes tables for fire resistance and reinforcement details.